

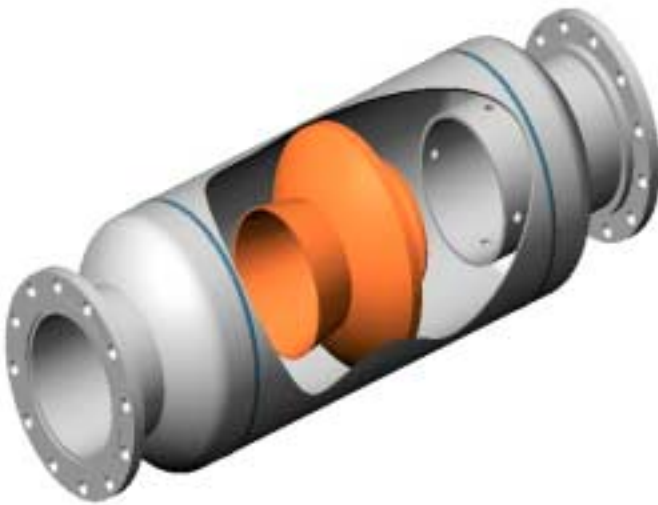

Model RCS Silencer For Roots Type Blowers

The Flo-Dyne model RCS silencer is an up-dated version of the classic reactive-type acoustic filter. It is applied to low and medium frequency noise sources. One of the difficulties in the past in using this type of design has been the designers inability to accurately determine performance over a variable frequency range.



Flo-Dyne's computer software can analyse and predict the performance of each model of RCS silencer proposed. The programme allows the designer to adjust dimensions and observe how performance of the silencer is affected. Selection of an appropriate model by the design engineer is therefore made to suit each individual application rather than the use of standard silencers chosen from a range.

The computer software has been verified with field data with suitable correction factors to account for installation variation and effect that can significantly affect theoretical performance.

The RCS silencer is built to handle the most severe conditions imposed by rotating machinery due to the pressure pulsation and vibration loadings typically experienced. Carbon steel construction is standard using certified materials and ASME IX welders for the construction. High alloy and special materials are available to suit the process requirements.

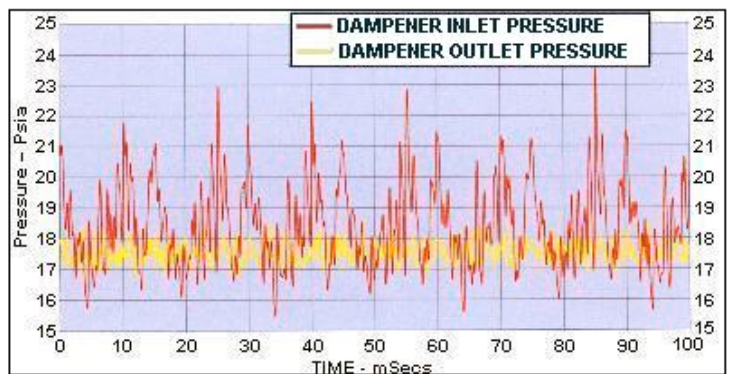

The Flo-Dyne model RCS silencer may be used on low to medium frequency noise sources. Typical silencing applications would include lobe-type rotary blowers, sliding vane type rotary blowers and any intermittent flow service.